



**DT-HF8010K 8K HDMI  
Armor optical fiber cable**

Please read the product manual carefully before using the product

# 8K HDMI Armor Fiber Cable Manual - User manual

## I、 Product description

This product is an armored fiber optic HDMI 2.1 cable, which has a thicker steel cable layer than the ordinary fiber optic HDMI 2.1 cable, which can greatly prevent the fiber optic HDMI cable from being trampled, heavily pressed, and bent to cause damage to the cable. It has better flexibility and bendability, even if it is folded in half, there is no need to worry about the fiber core breakage and damage in the armored optical fiber HDMI cable 2.1, which is more convenient and quicker for the tube to drag the cable. Since the thick steel armor metal layer is fully wrapped, compared with the addition of a thick shielding layer, it can better isolate and protect electromagnetic interference and electromagnetic radiation. Especially for some medical systems, security monitoring systems and other places that require strict electromagnetic isolation, the armored optical fiber HDMI cable version 2.1 has a better application effect. Suitable for digital home theaters, classrooms, security cameras, meeting rooms, auditoriums, LED billboards, outdoor advertising, airport and stadium panel information display, etc.

## II、 Product parameters

1. 8K HDMI 2.1 Armor fiber optic cable.
2. Support 8K\*4K@60Hz, 4K@60Hz/120Hz/144Hz and other resolutions.
3. Using photoelectric conversion chip, the signal transmission bandwidth is 48Gbps.
4. Compatible with Dolby Panorama, Dolby Vision, HDCP2.2 and 2.3,3D,DTS:X, Dynamic HDR, ALLM, QFT, QMS, VRR.
5. Use metal armor photoelectric composite cable four-fiber seven-copper core structure, anti-interference and tensile strength.
6. The appearance of the product is made of zinc alloy, which is resistant to compression and wear, and the port is gold-plated to ensure stable signal transmission.
7. Widely used in large-screen broadcasting, e-sports games, home audio-visual, multimedia video playback and other display places.

### III、 Installation matters

- Carefully open the contents of the shipping group and shut down the entire system before connecting
- Plug the "Source" silver shell connector of the DTECH cable directly into the HDMI output port of the video source (DVD, Blu-ray, game console, etc.). Make sure the cable is inserted firmly.
- Plug the "Display" black housing connector of the DTECH cable into the HDMI input port of the monitor (HDTV, LCD screen, projector, etc.). Make sure the cable is inserted firmly.
- Turn on the power of the signal source and the display

Note: Do not connect any intermediate cables or adapters between them as this may result in degraded signal transmission performance.

- Screen distortion or display noise

Check that the picture resolution is set correctly for the source. For the signal source device, check whether the signal enhancement mode of the device is required, and display whether the device supports the output resolution of the signal source;

### IV、 Safety Precautions

- Before cleaning, please unplug the power plug of this unit from the video screen device. Do not use liquid or spray cleaners. Use only a damp cloth.
- Keep away from moisture, magnetic and flammable surfaces or substances.
- Do not place any heavy objects or equipment on top of the device.
- When encountering product quality problems, please consult our after-sales department first. Non-professionals are not allowed to disassemble the shell without authorization to avoid product damage.

## V、 Connection Diagram

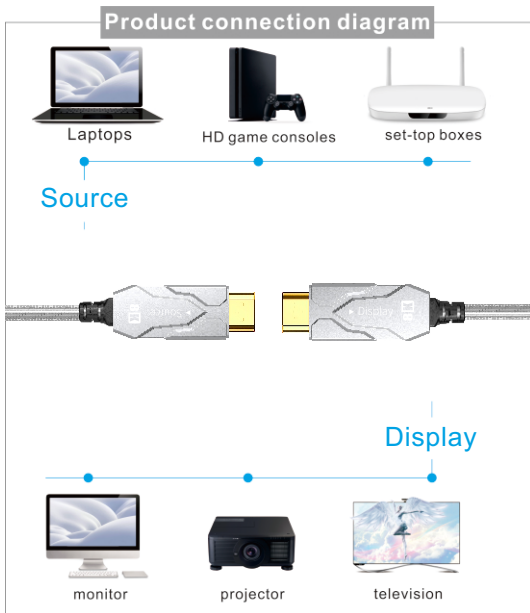

# Warranty card

## customer information

model	
date of purchase	
customer phone number	
customer address	
dealer	
dealer address	
dealer phone number	dealer stamp valid

## Warranty record

repair frequency	date	failure	treatment measures	maintenance number